



TRIMO

VISITORS SAFETY

Dear visitors!

Welcome to Trimo, one of Europe's leading providers of building envelope solutions, which has been providing its customers with original and comprehensive roof, façade and modular units for over 60 years.

Trimo is a modern and well-organised high-tech company that markets its solutions under its own brand in more than 100 countries across the globe. Its production facilities are located in Slovenia and Serbia.

We hope you, as a visitor and guest, enjoy your visit to our company.

WELCOME TO TRIMO!

As Trimo is a manufacturing company, with your safety as its main consideration, we cordially ask you to follow the instructions below during your visit:

- Upon arriving at Trimo, proceed to the main entrance to familiarise yourself with important instructions and rules for a safe visit around the company.
- Please use the marked pedestrian walkways and crossings.
- Please walk carefully and avoid running on company grounds, especially on stairs, in low visibility areas and on slippery surfaces.
- Please stay with the authorised Trimo representative at all times while on company grounds.
- Please observe the safety signs and the instructions of the authorised Trimo representative.
- Wearing an orange reflective vest is mandatory on company facilities. In production areas or warehouses, protective footwear with a toe cap is also required.
- Please keep close to your group if you are visiting in a large group.
- The maximum speed limit is 10 km/h outside the premises and 5 km/h inside the premises. Please park only in designated parking locations.
- Drivers of commercial vehicles must use safety shoes and an orange reflective vest.
- Do not walk under suspended loads.
- It is prohibited to use open flames in the company area without the prior written permission of the authorised person.
- Food and drink can be consumed only at the designated locations (dining hall).
- For security reasons, the company grounds are under video surveillance.

INSTRUCTIONS FOR SAFE WORK – USE OF WALKWAYS



Keep to the walkways!

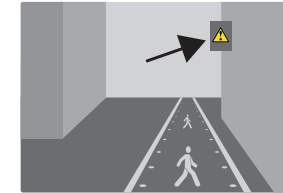

Pay attention to the warning signs and other vehicles!



Stand clear of the forklift or crane while it is loading/unloading cargo!



Make sure you have been seen by other traffic participants before crossing!



Walking on transport routes is dangerous. These are intended for vehicles!

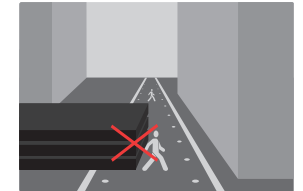

The walkways must be without obstacles!

**IMPORTANT:
FORKLIFT DRIVERS
HAVE A REDUCED
FIELD OF VISION!**

PEDESTRIAN'S VIEW

FORKLIFT DRIVER'S VIEW

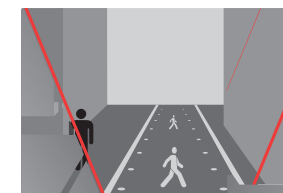

VISITOR TOUR OF THE ENTIRE TRIMO FACILITY

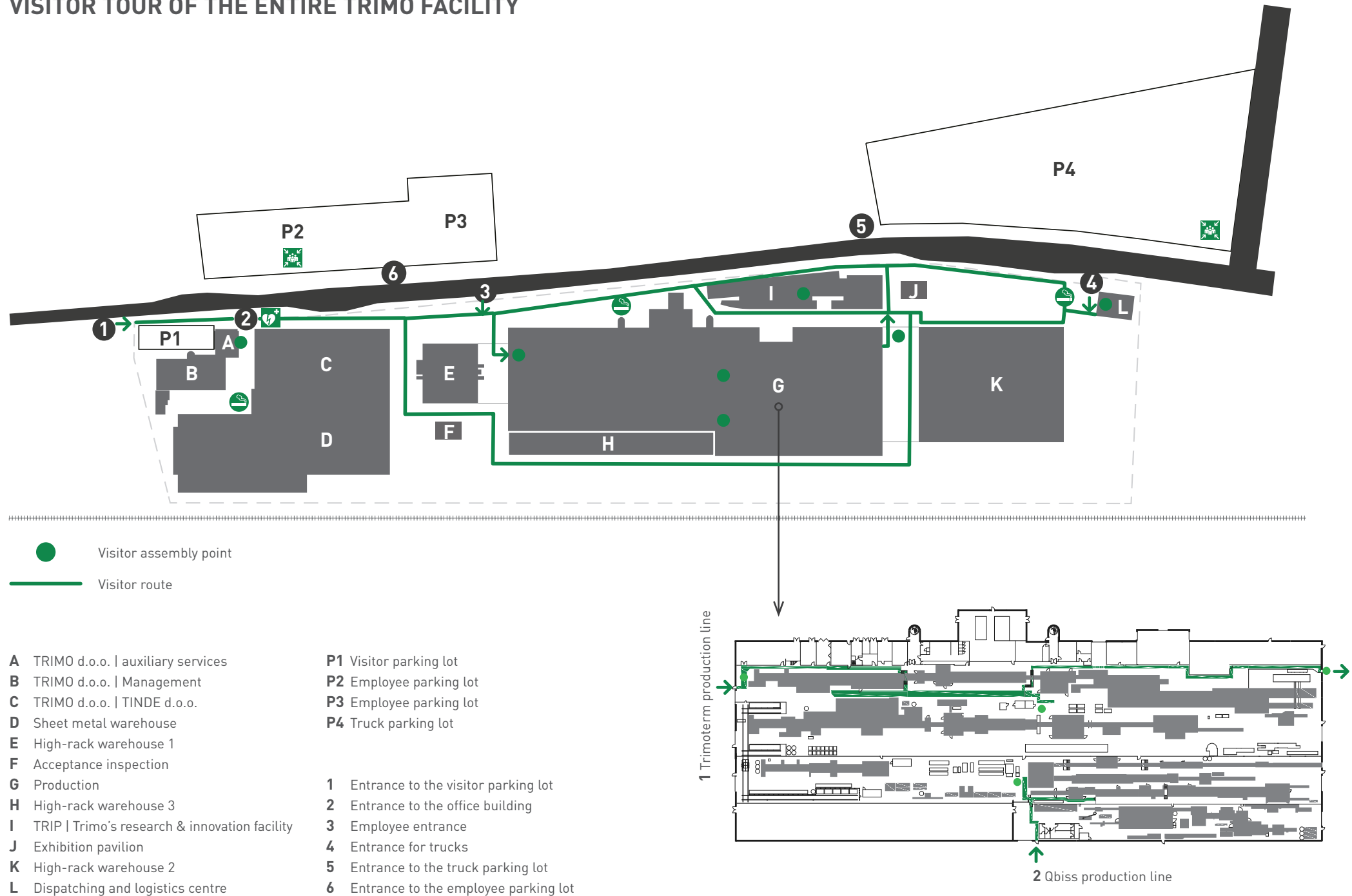

VISITOR TOUR OF THE PRODUCTION FACILITIES

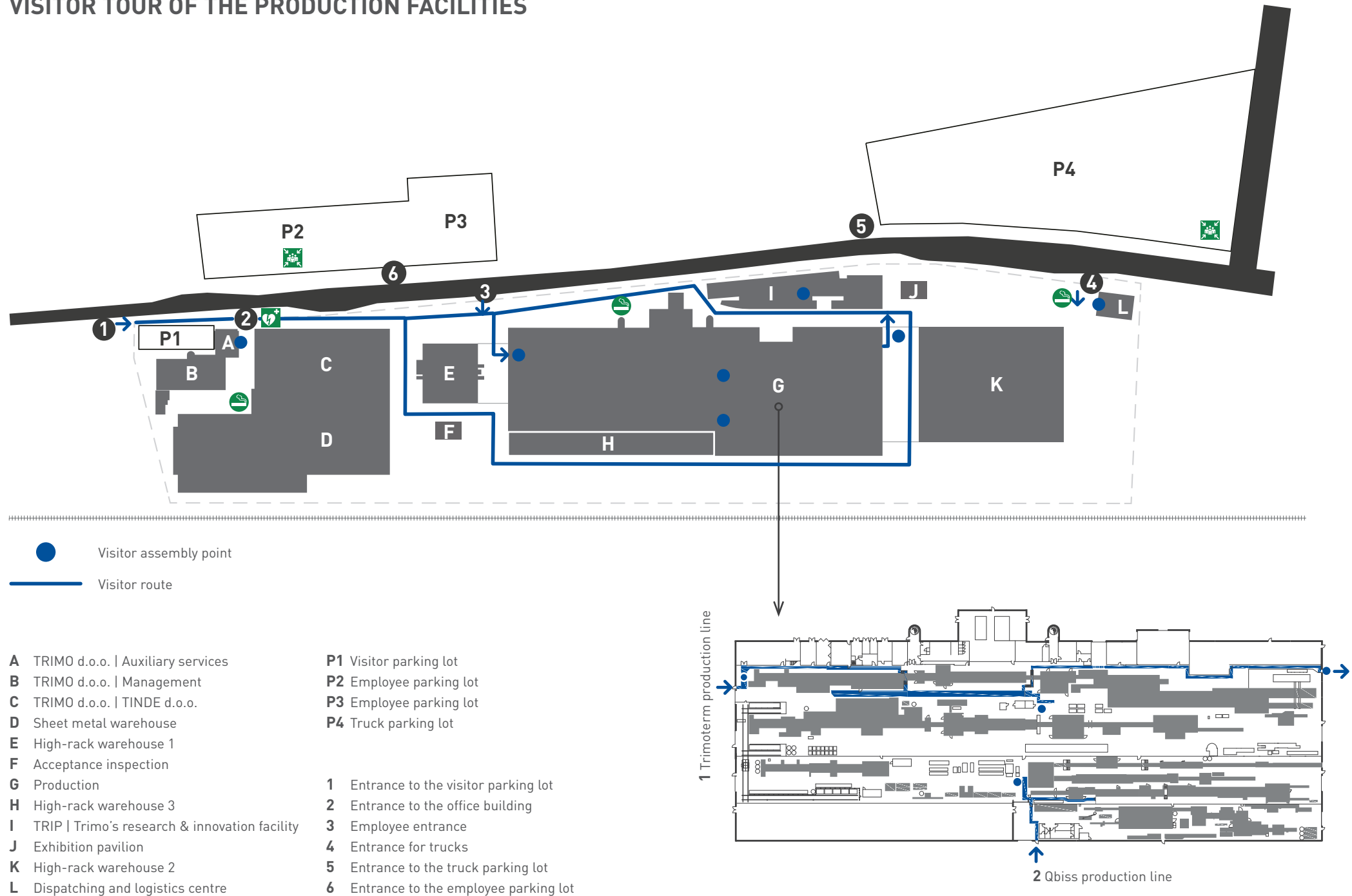

VISITOR TOUR OF THE TRIMOTERM PRODUCTION FACILITIES

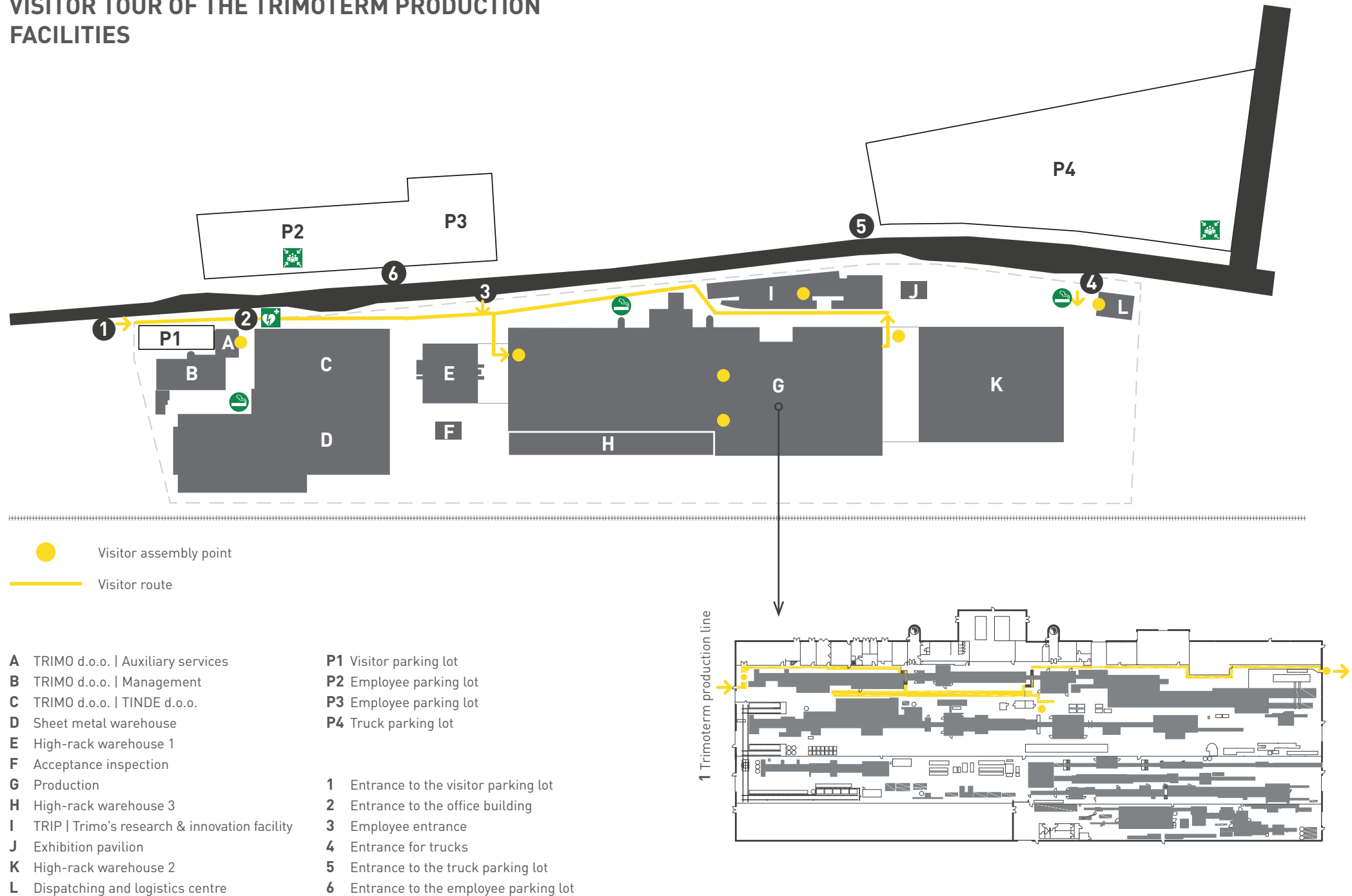

EMERGENCY ACCESS ROUTE

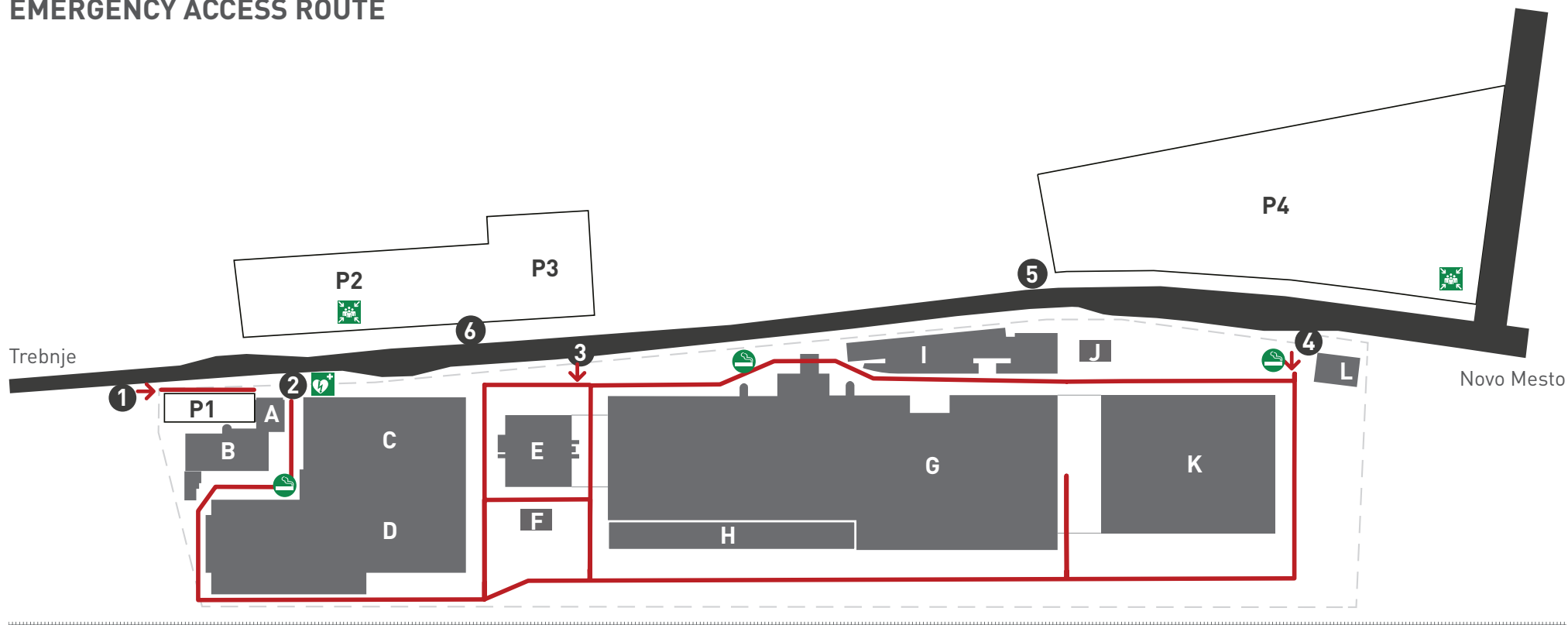

 Emergency access route

- A** TRIMO d.o.o. | Auxiliary services
- B** TRIMO d.o.o. | Management
- C** TRIMO d.o.o. | TINDE d.o.o.
- D** Sheet metal warehouse
- E** High-rack warehouse 1
- F** Acceptance inspection
- G** Production
- H** High-rack warehouse 3
- I** TRIP | Trimo's research & innovation facility
- J** Exhibition pavilion
- K** High-rack warehouse 2
- L** Dispatching and logistics centre

- P1** Visitor parking lot
- P2** Employee parking lot
- P3** Employee parking lot
- P4** Truck parking lot
- 1** Entrance to the visitor parking lot
- 2** Entrance to the office building
- 3** Employee entrance
- 4** Entrance for trucks
- 5** Entrance to the truck parking lot
- 6** Entrance to the employee parking lot

Please observe the following signs throughout the company area:



No photography or filming is allowed



No touching of process and work equipment



Evacuation assembly point



Automated External Defibrillator



Smoking is allowed in the smoking area.

Emergency calls:

- Reception:
+386 7 34 60 200
- Fire/rescue services:
112
- Police:
113
- Trebnje Community Health Centre:
+386 7 34 81 740

TRIMO

TRIMO D.O.O.
PRIJATELJEVA CESTA 12
8210 TREBNJE | SLOVENIA
T: +386 7 34 60 200
E: TRIMO@TRIMO-GROUP.COM
W: WWW.TRIMO-GROUP.COM